

AENEAS

Coffee Table

Handcrafted coffee table in marble with inlaid linear pattern in oxidized brass.
Marble surface and marble base consisting of two angular elements following the angular pattern of the brass on the surface.

SPECIFICATIONS

MATERIALS

As Pictured:
Tinos dark green marble
Brass in light oxidation

DIMENSIONS

W: 75cm / 29.52"
D: 70cm / 27.56"
H: 33cm / 12.99"

CUSTOMIZATION

Available in custom size,
type of marble, color of brass oxidation
and finish, upon request.

TECHNICAL DRAWING

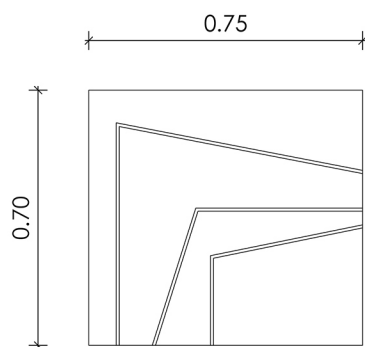

PLAN

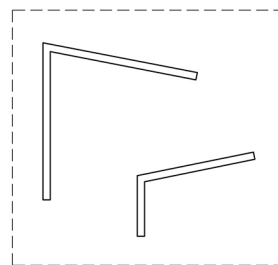

BASE

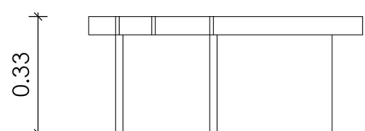

FRONT